

Aperio wireless locks and AEOS

Linked solutions



How it works

AEOS classic installation

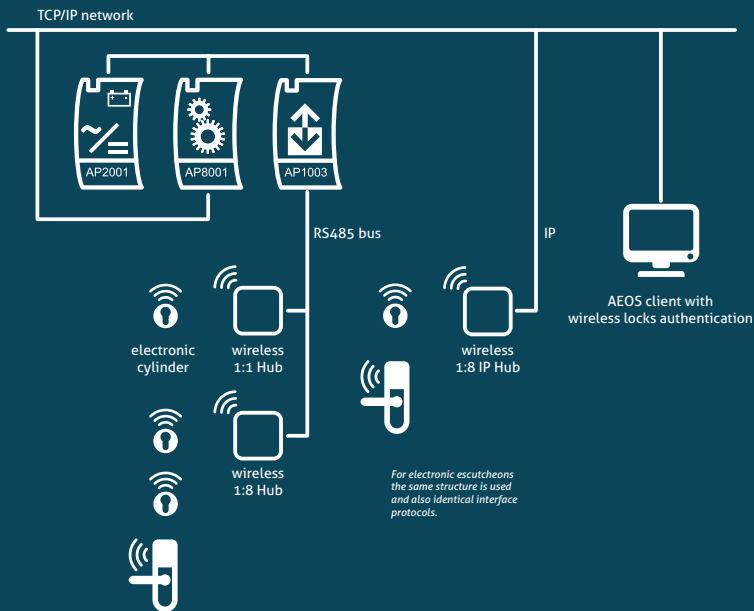

AEOS Blue installation

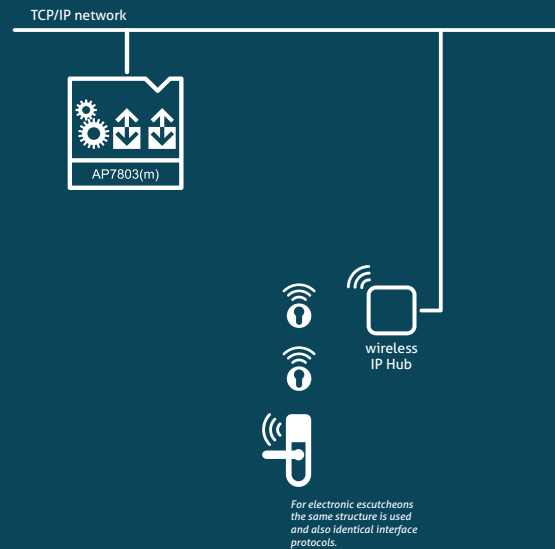

The locks communicate with a wireless hub in an ASSA ABLOY Aperio system. When a card is presented to the reader in a cylinder or escutcheon, the number is sent to a wireless hub and forwarded to the AEOS door controller. When the person is authorised, an unlock message is sent back, via the wireless hub, to the cylinder or escutcheon and the door is unlocked.

A wireless hub can handle a maximum of eight electronic cylinders or escutcheons. The models supported by AEOS are:

- RS485 (AH30 - 1:8)
- IP hub (AH40 - 1:8)

A wireless hub can only be connected in an RS485 bus to the AP1003 (AEOS door controller). Which means you can only use the RS485 hub in an AEOS Classic installation.

The IP hub uses the existing IP network, which makes it independent. So it can be used in an AEOS Classic and/or an AEOS Blue installation.

Wired & wireless on one platform

Many organisations now control and monitor access to their buildings using an electronic online system. This type of access control platform offers great benefits in terms of controllability and security. However, there are downsides, as it's time consuming to install electromechanical locks, card readers and wiring. So inner perimeter doors are very often equipped with mechanical key locking systems instead.

Nedap, in collaboration with ASSA ABLOY, has addressed this challenge. The integration of ASSA ABLOY's wireless Aperio locks into Nedap's AEOS access control system allows you to use both wired and wireless locks. Most importantly, you can manage them in just one security platform.

All of your doors, whether wired or not, are connected to your online access control system. In AEOS, the same authorisation schemes are used for wired and wireless doors, allowing you to monitor and control both high security and inner perimeter doors easily, while keeping investment low. With this Aperio integration, Nedap now offers a truly all-round access control system. One that enables you to benefit fully from everything electronic access control has to offer.

Increase security & convenience

Doors equipped with wireless locks behave just like online doors, while doors needing a high level of security can be monitored and controlled by your online system. If necessary, you can also add extra security measures such as intrusion detection, biometrics or video surveillance. In the past, low-cost, easy-to-manage RFID cards could only be used at doors wired to your electronic access control system. Access to all other doors was still dependent on traditional patented keys, which are hard to keep track of. Now, you can use RFID cards on all of your doors.

Accurate authorisations

AEOS has a unique model for easy but accurate authorisation management. It treats wired and wireless doors no differently, allowing you to use the same

authorisation templates for enrolment and monitoring. When a card is presented, the electronic cylinder or escutcheon unlocks the door. This can be permanent, like a mechanical key, or effective for just a few seconds to maintain a high level of security. If the door has an escutcheon, you can simply open the door after presenting your card, making it a very convenient option.

Minimise risk

You can also restrict access authorisations in several ways. This allows you to reduce potential security risks by improving the control of people flow in your buildings. AEOS also improves security by offering several functions to minimise the impact of lost or stolen badges.

Is this integration right for you?

Integrating Aperio wireless locks into your online AEOS system is a good choice if:

- Mechanical locks don't offer enough flexibility or security.
- You need to monitor doors in real-time.
- You want to avoid cabling.

The benefits of integrating Aperio into AEOS

- One single management platform for both online and Aperio doors.
- Maximum security for online wired doors.
- No cabling needed for Aperio doors.
- AEOS allows your security and facilities departments to take separate responsibilities.

The greatest benefit, of course, is that you can control both wireless and wired doors using one single management platform – AEOS.

